

Integra Range - Moulded Case

TAI200, TAI210, TAI230, TAI233



DESCRIPTION

A range of current transformers with general features as described on page 48 of this catalogue. All units in this range offer moulded fixings for foot, DIN rail, or busbar mounting, along with integral moulded terminal covers. Secondary connection may be made by fast-on connector or screw terminals. Models TAI 312 and TAI402 offer class 0.2 accuracy.

TAI200

Cable Aperture 22mm dia
Busbar Window 20x5mm
Secondary Terminals M4 screws/
 6.3x0.8mm fast-on
Weight 270g

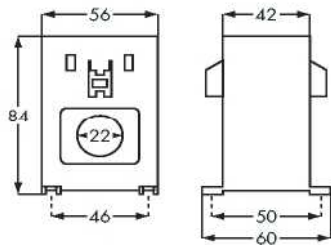

Primary current A	Burden		
	cl. 0-5 VA	cl. 1 VA	cl. 3 VA
50	-	-	2
60	-	-	2-5
70	-	-	3
75	-	-	3
80	-	-	3
100	-	2	4
120	-	3	5
125	-	3	5
150	2	4	6
200	3	6	8
250	5	8	10

1A or 5A secondary

TAI210

Cable Aperture 17mm dia
Busbar Window 20x5mm
Secondary Terminals M4 screws/
 6.3x0.8mm fast-on
Weight 220g

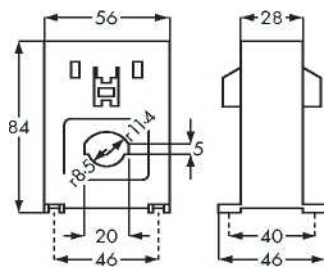

Primary current A	Burden		
	cl. 0-5 VA	cl. 1 VA	cl. 3 VA
50	-	-	1-5
60	-	-	1-5
70	-	-	3
75	-	-	2
80	-	-	2
100	-	1-5	2-5
120	-	2	3
125	-	2	3
150	-	2-5	4
200	2	4	6

1A or 5A secondary

TAI230

Cable Aperture 23mm
Busbar Window 30x10mm,
 25x12mm
 20x11mm
Secondary Terminals M4 screws/
 6.3x0.8mm fast-on
Weight 270g

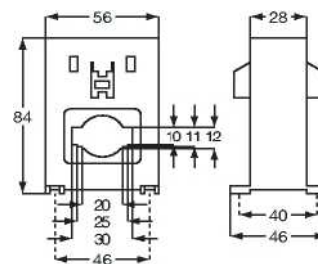

Primary current A	Burden		
	cl. 0-5 VA	cl. 1 VA	cl. 3 VA
150	-	-	1-5
200	-	2	3
250	-	2	3
300	2	3	4
400	3	4	5
500	4	5	6
600	5	6	8

1A or 5A secondary

TAI233

Cable Aperture 23mm
Busbar Window 30x10mm,
 25x12mm
 20x11mm
Secondary Terminals M4 screws/
 6.3x0.8mm fast-on
Weight 270g

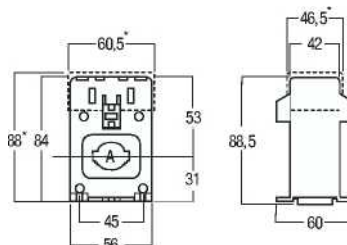

Primary current A	Burden		
	cl. 0-5 VA	cl. 1 VA	cl. 3 VA
40	-	-	1.5
50-60	-	-	2.5
70	-	-	3
75	-	1.25	3.5
80	-	1.5	4
100	-	2.5	5
120	-	3.5	5.5
125	1	4	5.5
150	1.5	5.5	6.5
200	4	7	8.5
250	6	9	11
300	7.5	11	13.5
400	10.5	15	18
500	12	18	22
600	14.5	21.5	26

1A or 5A secondary